

**Key:**  
 PROPOSED 2016  
 Phase II Mill  
 & Overlay

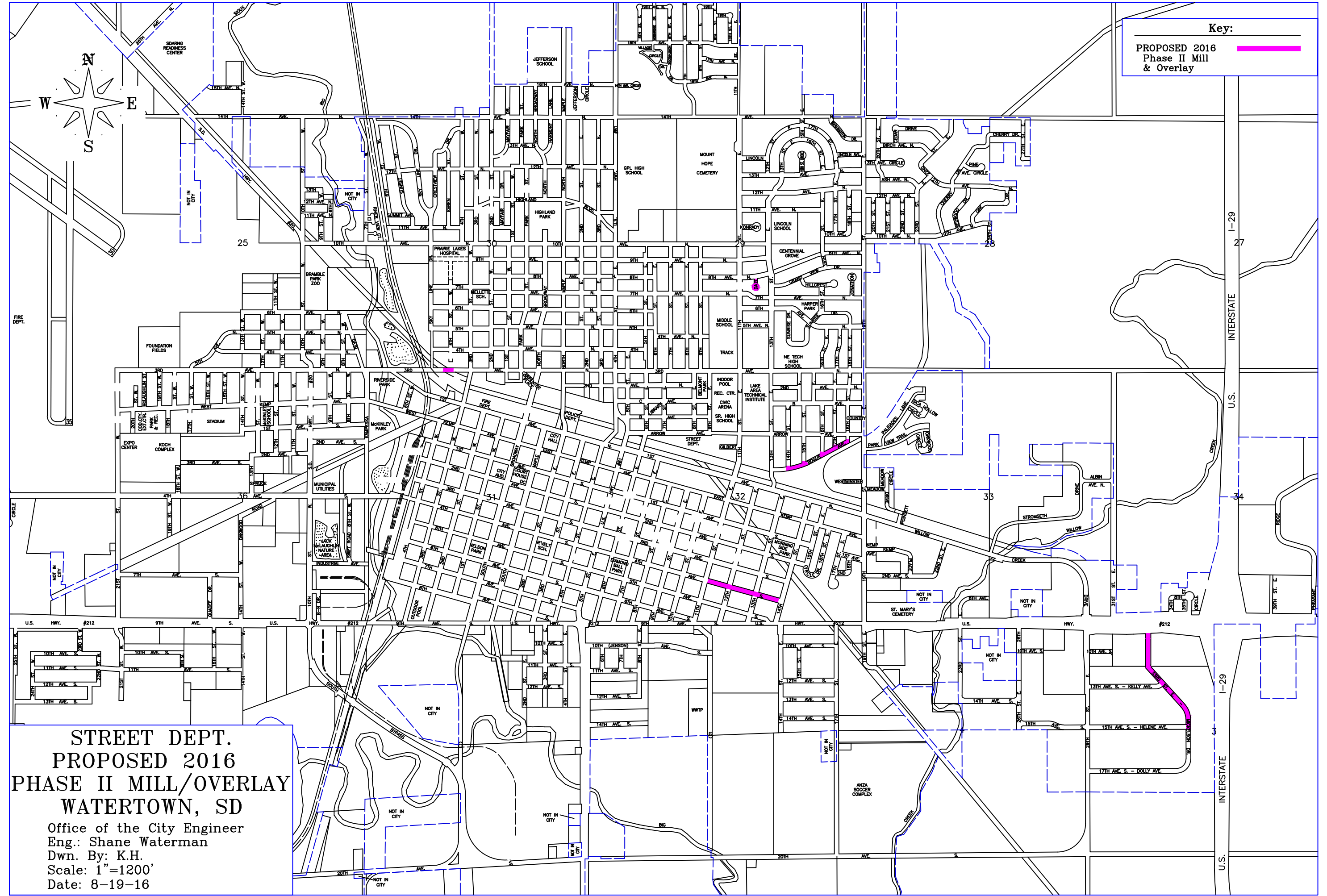

**STREET DEPT.  
 PROPOSED 2016  
 PHASE II MILL/OVERLAY  
 WATERTOWN, SD**  
 Office of the City Engineer  
 Eng.: Shane Waterman  
 Dwn. By: K.H.  
 Scale: 1"=1200'  
 Date: 8-19-16