

**NOTE:**  
 Precinct 3 will start at the intersection of North Lake Drive and South Lake Drive on the east side of Lake Kampeska and will take in any additions south of the lake within the city limits and will continue west and north to North Lake Drive. Precinct 4 will start at the intersection of North Lake Drive and South Lake Drive on the east side of Lake Kampeska and will take in any additions north of the lake within the city limits and will continue west and south to South Lake Drive.

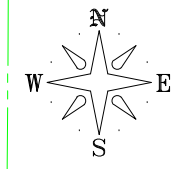
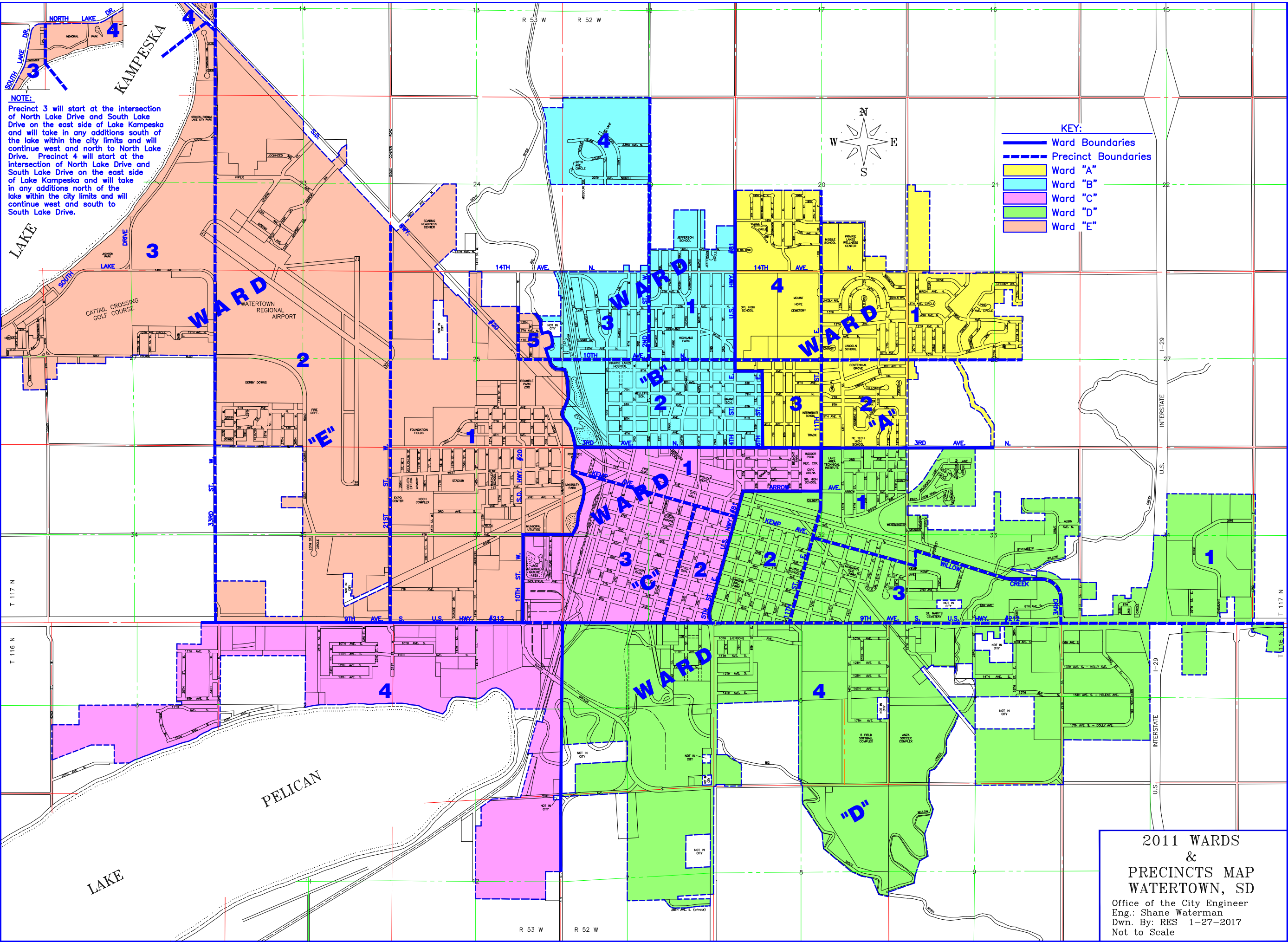

- KEY:**
- Ward Boundaries
  - Precinct Boundaries
  - Ward "A"
  - Ward "B"
  - Ward "C"
  - Ward "D"
  - Ward "E"

**2011 WARDS  
 &  
 PRECINCTS MAP  
 WATERTOWN, SD**

Office of the City Engineer  
 Eng.: Shane Waterman  
 Dwn. By: RES 1-27-2017  
 Not to Scale